

Central Hill Campus Parking Update

Emily Monea, SomerStat Director

Brad Rawson, Director of Transportation & Infrastructure

Agenda

1. Project timeline
2. RFP for off-site, off-street parking spaces
3. Parking regulations on Highland Ave.
4. Snow emergency parking data
5. Next Steps



Our Original Understanding of the Project Timeline

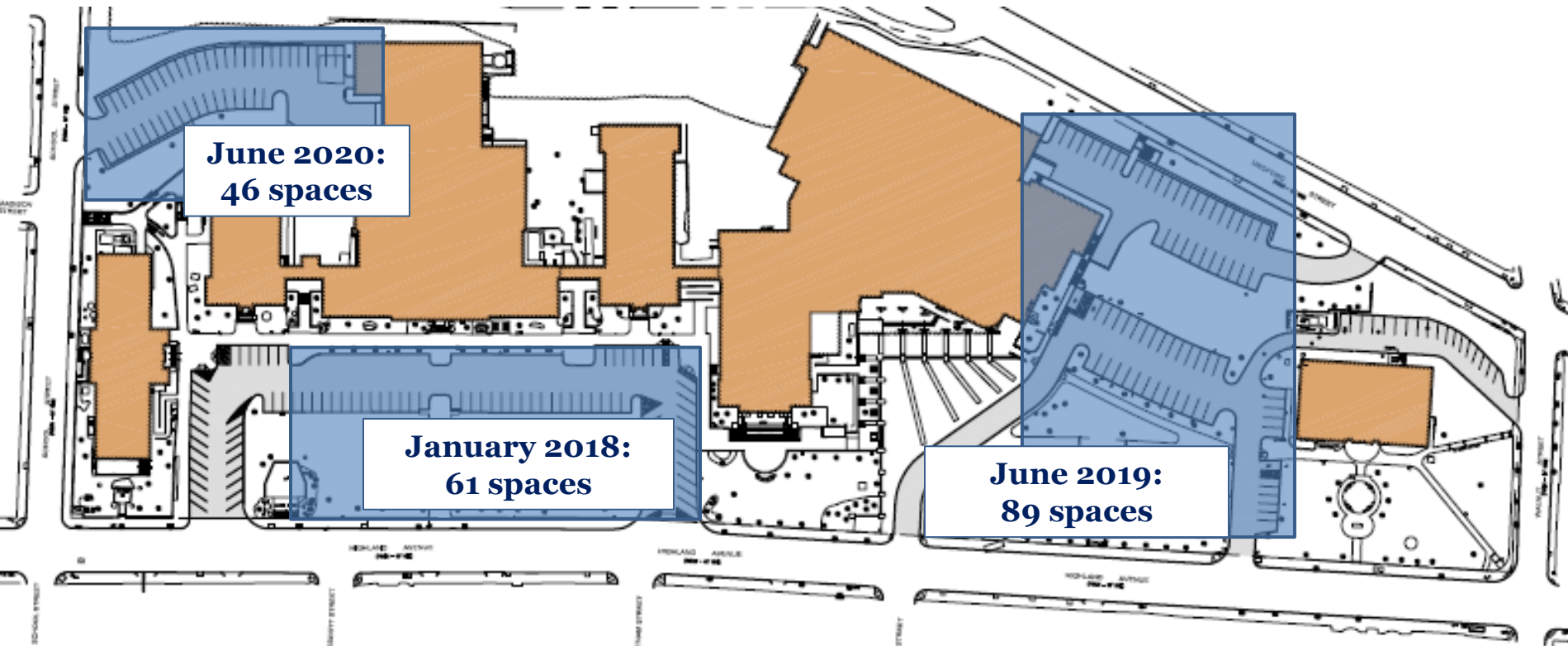

- December 2017: City Hall staff given permits to park on-street

The Actual Project Timeline

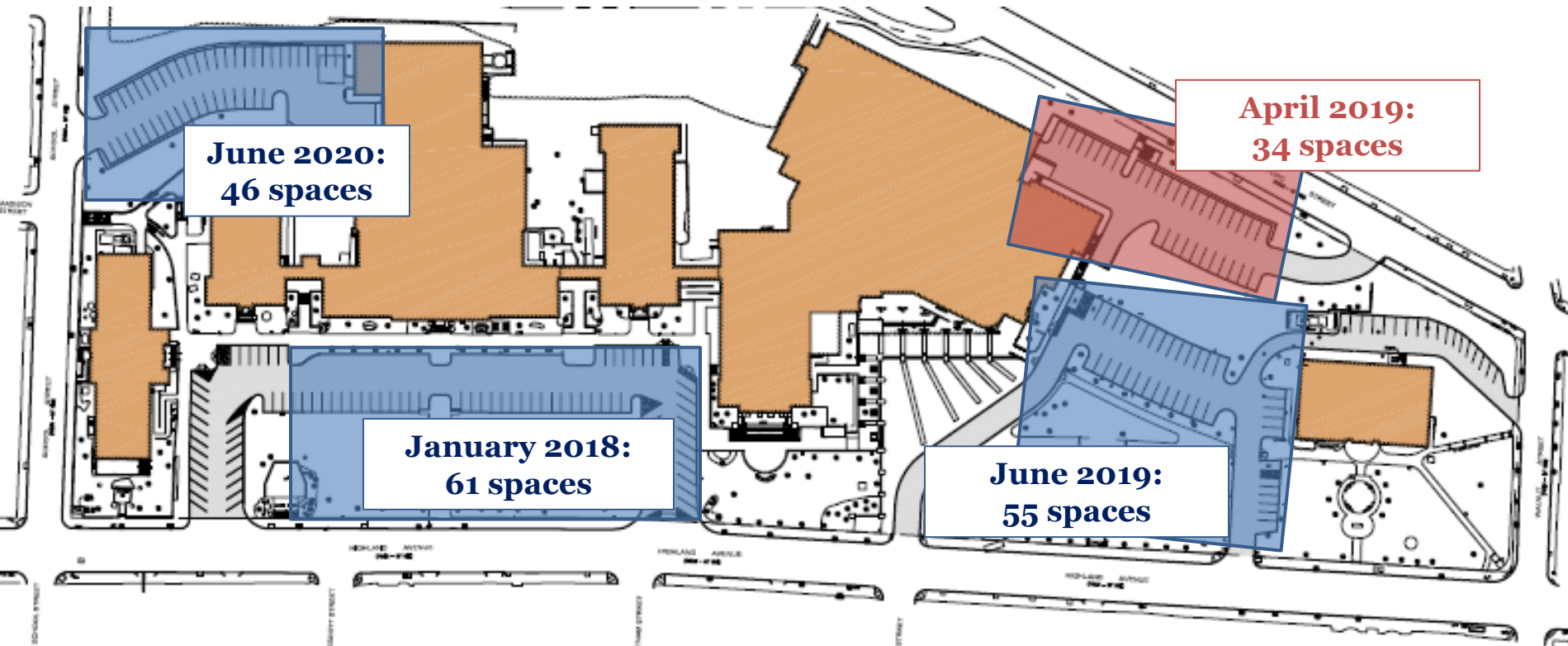

- December 2017: City Hall staff given permits to park on-street

Interim response to parking change

- Allow SHS staff to park at 90 Washington St. through the end of June 2019
 - DPW cleaning lot and addressing fencing
 - City will install a security camera & signage noting the lot is only available for SHS staff parking
- City working to identify transportation options to get staff from 90 Washington St. to Central Hill
 - Options: BridgeHopper; on-demand ride hailing

Next step: RFP for off-site, off-street parking spaces

- Goal: provide predictable off-site, off-street parking for Central Hill Campus staff
 - Reduce on-street parking & impact to residents
 - Reduce time spent by staff finding a parking spot
- Approximate timeline:
 - April/May: release RFP
 - May/June/July:
 - Select preferred lots
 - Execute leases with property owners
 - Requires City Council approval & funding authorization
 - Identify transportation options if needed
 - Mid-August: parking spaces available

Minimum Requirements for RFP

- **Location:** within 3 miles of City Hall
- **Size:** minimum of 6 parking spaces
- **Availability:** exclusive use by City and School employees Monday-Wednesday 6am to 5pm; Thursday 6am to 8pm; Friday 6am to 1pm
- **Condition:** must be paved; pavement must be in generally good condition
- **Security:** must be a security camera
- **Maintenance:** property owner responsible for all maintenance, including but not limited to paving, cleaning, snow removal, and lighting

Process for Selecting Preferred Sites

- Review of RFP responses & recommendation by Parking Working Group. Responses will include:
 - Facility location and dimensions, parking layout & number of parking spaces offered, average parking space dimensions, locations of entrance(s) and exit(s), location(s) of light(s), location(s) of security camera(s) (either existing or proposed)
- Approval by Mayor & City Council

Parking Regulations on Highland Ave. near Central Hill Campus

- Goal: discourage contractor parking
 - SHS project agreement requires contractors to park off site
- Existing regulation allows for ticketing only
- Proposed regulation would allow for ticketing and towing
- Timeline:
 - Install signage as soon as its available
 - April or May: seek Traffic Commission approval

Snow Emergency – Wednesday, March 6th, 2019

Engineers + Planners

Total Loss of Spaces

On-Street

150 of 1449

-10.4%

Off-Street

0 of 182

-0.0%

Legend

Parking Occupancy

- Did not reach capacity
- Reaches 85-100% capacity
- Reaches over 100% capacity

- Campus buildings
- Campus parking lots
- Focus Area



Snow Emergency – Thursday, March 7th, 2019

Engineers + Planners

Total Loss of Spaces

On-Street

125 of 1449

-8.6%

Off-Street

1 of 182

-0.5%

Legend

Parking Occupancy

- Did not reach capacity
- Reaches 85-100% capacity
- Reaches over 100% capacity

- Campus buildings
- Campus parking lots
- Focus Area

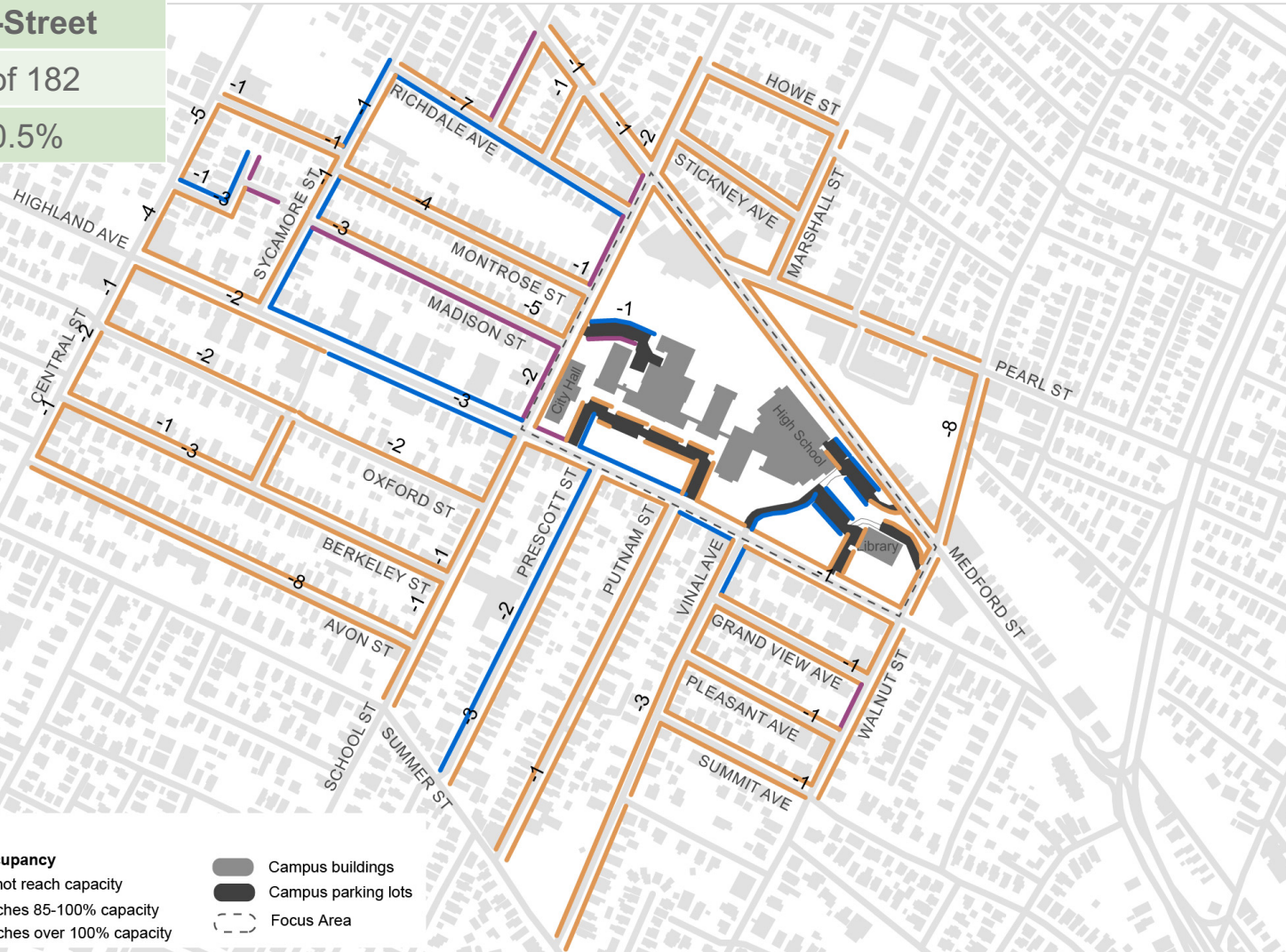

Snow Emergency – Summary

Engineers + Planners

Occupancy (Parked Cars/Supply)

	On-Street	On-Street %	Off-Street	Off-Street %
Average Midday May 8, 12, 14, and 15, 2018	878/1449	61%	168/182	92%
Snow Emergency Wednesday, March 6, 2019	790/1299	61%	179/182	98%
Snow Emergency Thursday, March 7, 2019	779/1324	59%	156/182	86%



HOWARD STEIN HUDSON

Snow Emergency – Future Conditions

Engineers + Planners

- **Midday, May 15th, 2018 Base**
 - Highest observed occupancy during midday condition

Study Area % Occupancy	
Existing Condition	66%
Future Conditions	
Phase 2A	70%
Phase 2A Snow Emergency	77%
Phase 2A Zone 2 Sweeping	88%
Phase 3	70%
Phase 3 Snow Emergency	78%
Phase 3 Zone 2 Sweeping	89%



Next Steps

Engineers + Planners

- **Estimate the impact of new staff and Green Line extension project on parking demand**
- **Conduct a visual survey of surrounding streets and identify locations where parking supply is not currently being maximized**
- **Provide recommendations to the City on managing the available parking supply around the Central Hill campus**



Next steps

- Release RFP for off-site, off-street parking
 - Conduct procurement process for transportation if needed
- Homan's Building parking lot scheduled to be available summer/fall 2019
- Continue analysis of resident and staff survey data
- Identify and implement short-term measures to incentivize reduced automobile use

Discussion

