

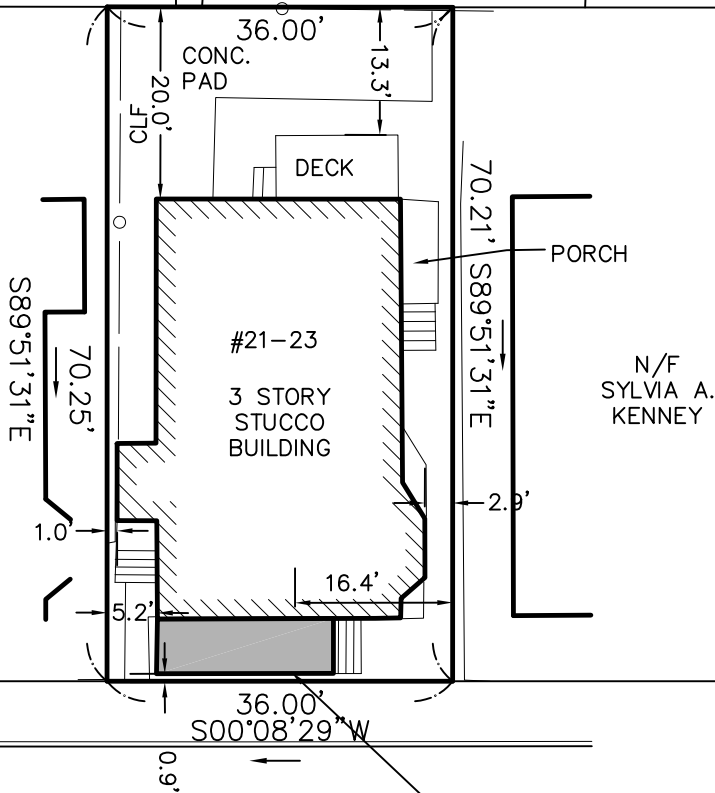

N/F  
NORTHEASTERN PROVINCE  
OF THE SISTERS OF NOTRE  
DAME, INC

S00°12'29"W



# MAGNUS STREET



General Notes  
THE EXISTING CONDITIONS SHOWN ARE FROM AN ACTUAL  
GROUND SURVEY CONDUCTED IN DECEMBER 2015.

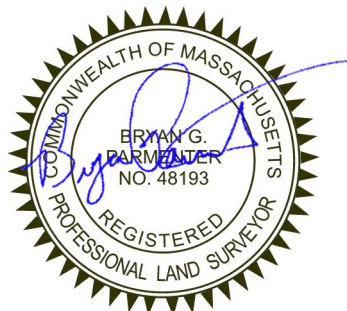

## PLOT PLAN IN SOMERVILLE, MASS.

21-23 MAGNUS STREET

SURVEY BY:

PFS LAND SURVEYING

SCALE: 1"=20' DATE: 12/26/2015