

**Addendum #1 IFB 21-55**



**CITY OF SOMERVILLE, MASSACHUSETTS**  
**Department of Purchasing**  
**JOSEPH A. CURTATONE**  
**MAYOR**

**To:** Arthur D. Healey School Tot Lot Construction  
**From:** Andrea Caruth, Assistant Director of Purchasing  
**Date:** March 05, 2021  
**Re:** Changes to specifications and responses to questions

**Addendum No. 1 to IFB 21-55**

---

This addendum presents changes to the specifications and answers requests for information (RFIs) submitted by prospective applicants to this IFB.

**\*\*Failure to acknowledge the addendum will result in bid disqualification.\*\***

**NAME OF COMPANY / INDIVIDUAL:** \_\_\_\_\_

**ADDRESS:** \_\_\_\_\_

**CITY/STATE/ZIP:** \_\_\_\_\_

**TELEPHONE/FAX/EMAIL:** \_\_\_\_\_

**SIGNATURE OF AUTHORIZED INDIVIDUAL:** \_\_\_\_\_

**ACKNOWLEDGEMENT OF ADDENDA:**

**Addendum #1** \_\_\_\_\_ **#2** \_\_\_\_\_ **#3** \_\_\_\_\_ **#4** \_\_\_\_\_

## **Addendum #1 IFB 21-55**

Question: In terms of the new playground equipment from landscape structures, are we expected to get a storage container to store the equipment safely or are we going to run this inside the safety fencing and just keep it?

Answer: It is reasonable to have a storage container. The vendor would be responsible for that equipment security once it is onsite. When it arrives, it becomes contractor's responsibility until installed and accepted. If equipment arrives before construction starts, City will be responsible until the construction starts.

Question: Would you be opposed to delivering the equipment to our yard and bringing it when it's time?

Answer: That can be arranged. We can have 5 or 6 parking spaces in the school parking lot so we have that as a minimum. The time of delivery for the equipment and construction will be tight.

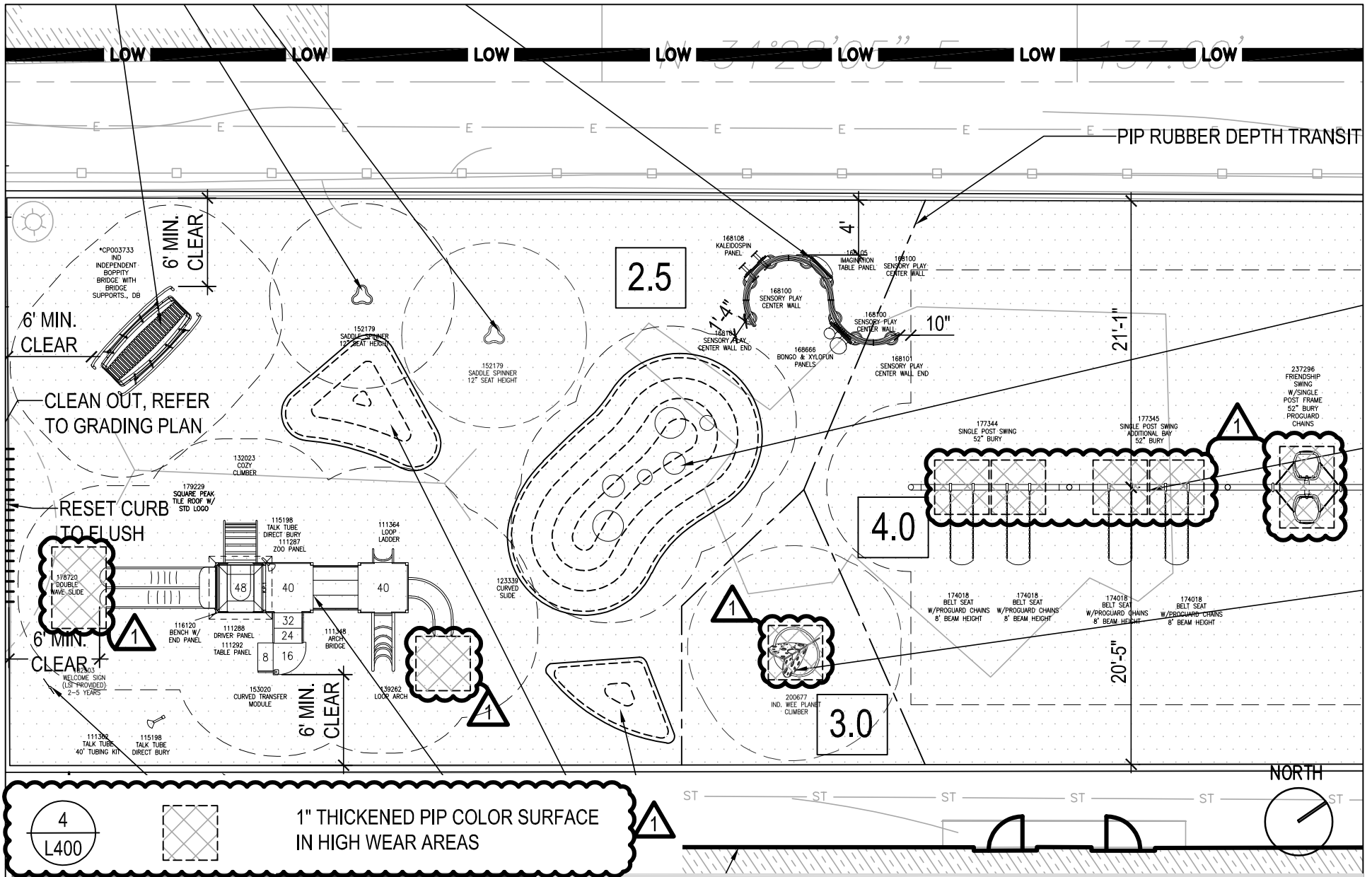

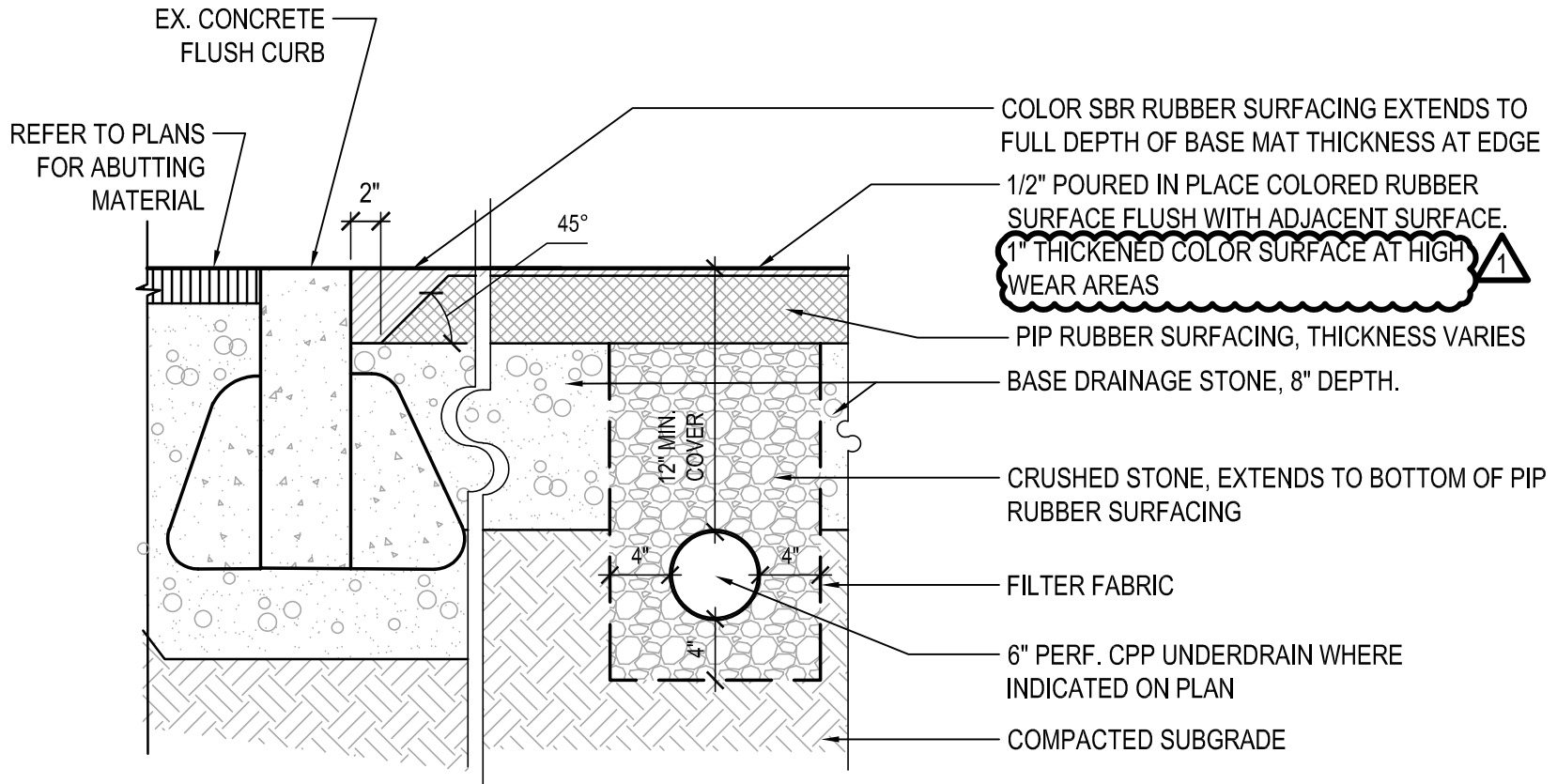

**NOTES:**

1. RUBBER BASE MAT THICKNESS VARIES.
2. MUST MEET CPSC SAFETY REQUIREMENTS.
3. PIP EDGE TO SLOPE DOWN TO SUBGRADE WHERE NO CURB/EDGE IS SHOWN ON PLAN.
4. 1" THICKENED COLOR SURFACE AT HIGH WEAR AREAS (BELOW SWINGS AND EXIT OF SLIDE). MIN. AREA TO BE 4'X4'. 1



130 WEST BROADWAY, BOSTON MA 02127

T 617.464.1440 F 617.464.1442

www.warnerlarson.com

Project

ARTHUR D. HEALEY TOT-LOT RENOVATION

Title

SKL-AD1-002: 4/L400 - PIP RUBBER SURFACING

Scale

1"=1'-0"

Date

03/05/2021