

Mayor Joseph A. Curtatone &  
Councilor J.T. Scott  
invite you to

# CONWAY FIELD & PLAYGROUND RENOVATION COMMUNITY SAFETY MEETING

MARCH 24<sup>TH</sup>, 2021 | 6:30PM - 8PM



MARCH 24<sup>th</sup>, 2021  
CITY OF SOMERVILLE

Weston & Sampson  
design studio



# AGENDA

---

**INTRODUCTIONS** | Project Team

**PROJECT UPDATES** | Public Meetings to Date | Schedule | EPA Factsheet

**WORK PLAN OVERVIEW - FOUR PHASES**

**EXISTING CONDITIONS & PROPOSED IMPROVEMENTS**

**REMEDIATION** | What the community can expect

**COMMUNITY IMPACTS & SAFETY MEASURES**

**PROJECT SCHEDULE & NEXT STEPS**

**QUESTIONS & COMMENTS**

# INTRODUCTIONS

---

## PROJECT TEAM

**Andrew Louw**, Public Space Planner & Project Manager  
City of Somerville, Public Space and Urban Forestry

**Gary Lipson**, On-Scene Coordinator  
U.S Environmental Protection Agency

**Zanetta Purnell**, EPA Community Involvement Coordinator  
U.S Environmental Protection Agency

**Brandon Kunkel**, RLA, Team Leader  
Weston & Sampson

**George Naslas**, PG, LSP, VP Environmental Practice Leader  
Weston & Sampson

# PUBLIC MEETINGS SUMMARY

---

## **PUBLIC MEETINGS TO DATE:** Information Sessions:

- March 29<sup>th</sup>, 2018
- December 5<sup>th</sup>, 2018
- May 29<sup>th</sup>, 2019
- December 16<sup>th</sup>, 2019
- November 17<sup>th</sup>, 2020
- March 24<sup>th</sup>, 2021 - TODAY

*Posted in: local newspapers, social media, cable wheel, City calendar, City Council, Portuguese, Spanish, and Haitian Kreyol liaisons*



# ANTICIPATED SCHEDULE

---

- February 2021 - *Project Out to Bid*
- **TODAY** - *Community Safety Meeting*
- Spring 2021 - *Estim. Started Date*
- Summer 2021– *Remediation Complete*
- Fall 2021– *Field Construction*
- Spring 2022 - *Estim. Completion Date*



PROJECT UPDATES  
CONWAY PARK



# Conway Park Site Somerville, MA

U.S. EPA | HAZARDOUS WASTE PROGRAM AT EPA NEW ENGLAND

## THE EMERGENCY RESPONSE AND REMOVAL PROGRAM

*responds to chemical, biological and radiological releases and large-scale national emergencies, including homeland security incidents. EPA conducts short term cleanups in the removal program when necessary to protect human health and the environment by either funding response actions directly or overseeing and enforcing actions conducted by potentially responsible parties.*



### INTRODUCTION

The 2.8-acre Conway Park Site, located at 550 Somerville Avenue, is owned by the City of Somerville and features a heavily used recreational complex that includes a large ballfield, children's playground, and splash pad. Currently the entire ballfield area is closed to the public and only a portion of the playground is open. The park is in a densely populated area and was formerly used for industrial purposes until the City acquired the property by tax deed taking initiated in 1937.

A virtual public meeting will take place on **Wednesday, March 24 at 6:30pm** to discuss the details of the cleanup plan and address any questions or concerns of City residents. For more information or to register to attend the meeting, please visit: [somervillema.gov/conwayfield](http://somervillema.gov/conwayfield)

### BACKGROUND

In 2017 the City, through its contractor, initiated environmental assessment work when investigating a failing retaining wall at Allen Court. Sampling revealed large amounts of construction and demolition debris that was used as sub-surface fill material across the ballfield along with elevated levels of polychlorinated biphenyls (PCBs) and lead above Massachusetts Contingency Plan (MCP) cleanup standards. The City worked closely with the Massachusetts Department of Environmental Protection (MassDEP) and a consultant between 2017 and 2019 to perform soil sampling at Conway Park to define the nature and extent of contamination.

### EPA'S INVOLVEMENT

On April 9, 2019, MassDEP requested EPA's assistance with cleaning up Site soil. Thereafter, EPA and the City agreed to address cleanup of the site under a carefully coordinated mixed-work approach, with EPA expected to spend up to approximately \$3 million in cleanup work and the City performing the rest of the work (estimated to

continued >

### KEY CONTACTS:

#### GARY LIPSON

EPA On-Scene Coordinator  
617-918-1274  
[lipson.gary@epa.gov](mailto:lipson.gary@epa.gov)

#### ZANETTA PURNELL

EPA Community Involvement Coordinator  
617-918-1306  
[purnell.zanetta@epa.gov](mailto:purnell.zanetta@epa.gov)

#### ERIK JOHNSON

Environmental Analyst  
Bureau of Waste Site Cleanup  
MassDEP  
Northeast Regional Office  
978-694-3392  
[erik.johnson@state.ma.us](mailto:erik.johnson@state.ma.us)

### ETOLL-FREE CUSTOMER SERVICE

1-888-EPA-7341

### LEARN MORE AT:

[response.epa.gov](http://response.epa.gov)



February 2021



cost at least \$3 million) under EPA oversight. The cleanup will include the removal of the source contamination by excavating and disposing of soils contaminated with PCBs greater than 50 parts per million (ppm), lead and potentially other hazardous substances and will eliminate the direct contact threat by providing sufficient cover material over any residual contamination.

### NEXT STEPS/WHAT TO EXPECT

EPA expects the overall cleanup will include site preparation (e.g., removing tree/vegetation, shutting off and/or removing utilities, creating access roads etc.); removal activities (e.g., excavating, transporting, and disposing of PCB-contaminated soil above 50 ppm); and site restoration.

The City has developed work and design plans for EPA approval and is conducting their bidding process for hiring contractors to undertake cleanup activities in the spring of 2021.

When site work begins, cleanup activities will be divided into four (4) phases, as follows:

- Phase 1 will focus on preparing the site to enable the removal and off-site disposal of contaminated soil. This work will include: removing and properly disposing of contaminated soil in the presently closed portion of the playground area and constructing an access road through the playground from Somerville Ave. onto the site; installing a decontamination zone to ensure that trucks are not spreading contamination beyond Site boundaries; adding to Site fencing; and placing a work trailer. This work will be conducted by the City with EPA oversight.
- Phase 2 will focus on removing all Site soils where PCBs are equal to or greater than 50 ppm. These hot-spot areas have been pre-identified through numerous rounds of sampling and analysis. Backfill for these excavations will be with soil excavated from remaining portions of the field where PCB concentrations remain below 50 ppm. Once these areas are brought to final grade, they will be covered with a geotextile fabric. EPA will conduct this work.
- Phase 3 will begin when EPA is nearing the end of its share of the cleanup work and will focus on the City preparing the site for final field construction. This work involves re-grading the field (without disturbing previously excavated areas) and preparing the field perimeter for installation of Site utilities and new trees. This work will be conducted by the City with EPA oversight.
- Phase 4 will focus on restoring the site for public use and includes: installing a drainage layer and synthetic turf; repairing and replacing retaining walls along the south and southeastern Site borders; installing all needed utilities and add-ons (bleachers, backstops) for the ballfield; redeveloping the playground, including installing a new splash pad; and properly disposing off-site any remaining contaminated soil at an appropriate off-site facility. This work will be conducted by the City with limited EPA oversight (as determined appropriate).

The timing and order of the above activities may shift as detailed planning is ongoing.

La EPA comenzará la limpieza de Conway Park a la brevedad para eliminar los contaminantes del suelo. Para obtener información en español, visite: [somervillema.gov/conwayfield](http://somervillema.gov/conwayfield)

A EPA começará a limpeza do Conway Park em breve para remover os contaminantes do solo. Para informações em português, visite: [somervillema.gov/conwayfield](http://somervillema.gov/conwayfield)

EPA ले माटोको दूषित पदार्थहरू हटाउन चाँडै नै कन्े पक्कको सफाई सुरु गर्नेछ । नेपालीमा जानकारीको लागि कृपया यहाँ जानुहोस् :

[somervillema.gov/conwayfield](http://somervillema.gov/conwayfield)

EPA pral kòmanse netwayaj Conway Park byento pou retire sòl kontaminan yo. Pou jwenn enfòmasyon an Kreyòl Ayisyen, tanpri vizite: [somervillema.gov/conwayfield](http://somervillema.gov/conwayfield)

## AVAILABLE TRANSLATIONS: Creole, Nepali, Portuguese, Spanish

# EPA FACTSHEET CONWAY PARK





## PHASE 1: SITE PREPARATION

- Traffic Management

## PHASE 2: EPA REMEDIATION

- Contaminated soil ( $\geq 50$ ppm Polychlorinated biphenyls (PCBs)) removed from site
- Area backfilled with soil containing less than 50ppm PCBs

## PHASE 3: PARK CONSTRUCTION

- Field & Splash Pad renovations
- Playground & Basketball Court improvements

## PHASE 4: REGULATORY SIGN-OFF

- Final review



# WORK PLAN OVERVIEW - FOUR PHASES

CONWAY PARK







# PROPOSED IMPROVEMENTS

## CONWAY PARK





## BACKGROUND:

- **Site history:** Bleachery & Dye works (1800s-1930s), Field (~1940s), renovated in 1976 & 2001
- **Uses today:** playground, splash pad, multi-purposed natural grass field (soccer, football, ultimate frisbee, little league, softball, kickball)
- **Project Overview:** 2016 Fields Master Plan & Necessity to address the structural integrity of retaining wall

## REGULATORY PROCESS:

Site is regulated by:

1. Massachusetts DEP - Mass. Contingency Plan (MCP), LSP Oversight
2. US EPA - Toxic Substance Control Act, PCB Sites, Approval Process

## TIMELINE TO DATE:

- **Dec. 2017:** Lead & PCBs found at Conway Park
- **Mar. 2018:** Supplemental testing, Notified MassDEP, Park Closed
- **June 2018:** Met with MassDEP & EPA
- **July - Dec. 2018:** Detailed site assessment and data evaluation
- **Jan. - June 2019:** Evaluation of Remedial Options, Conceptual Remedial Design
- **May 2019:** Test pits study
- **June - Sept. 2019:** Conversation with EPA
- **Sept. - Nov. 2019:** Evaluation of EPA/City Cost-Sharing Options

# REMEDIATION – WHAT THE COMMUNITY CAN EXPECT

CONWAY PARK





# OVERALL REMEDIATION STEPS

---

*\*Where EPA Funds can be used*

- 1.\* Pre-remediation site preparation measures taken
- 2.\* Contaminated soil ( $\geq 50$  ppm PCBs) excavated, removed, & disposed of off-site
- 3.\* Backfill area with soils below 50 ppm PCBs
4. Remove & Dispose of soil necessary for field construction
- 5.\* Install a barrier (geotextile fabric)
6. Construct Field & Other Site Improvements

REMEDIATION – WHAT THE COMMUNITY CAN EXPECT

CONWAY PARK





# PRE-REMEDICATION SITE PREPARATION

---

1. Construct a controlled entrance
2. Secure site (including the playground); basketball courts secured in Phase 3
3. Decontamination area for vehicles/staff exiting
4. Monitor for dust at site perimeter and in active work zones
5. *Additional regulatory and public safety measures*
6. Remove trees and topsoil from site
7. Cut and stockpile subgrade (< 50ppm PCBs) to rough grade elevations
8. Retaining wall construction

**PHASE 1: SITE PREPARATION**  
CONWAY PARK





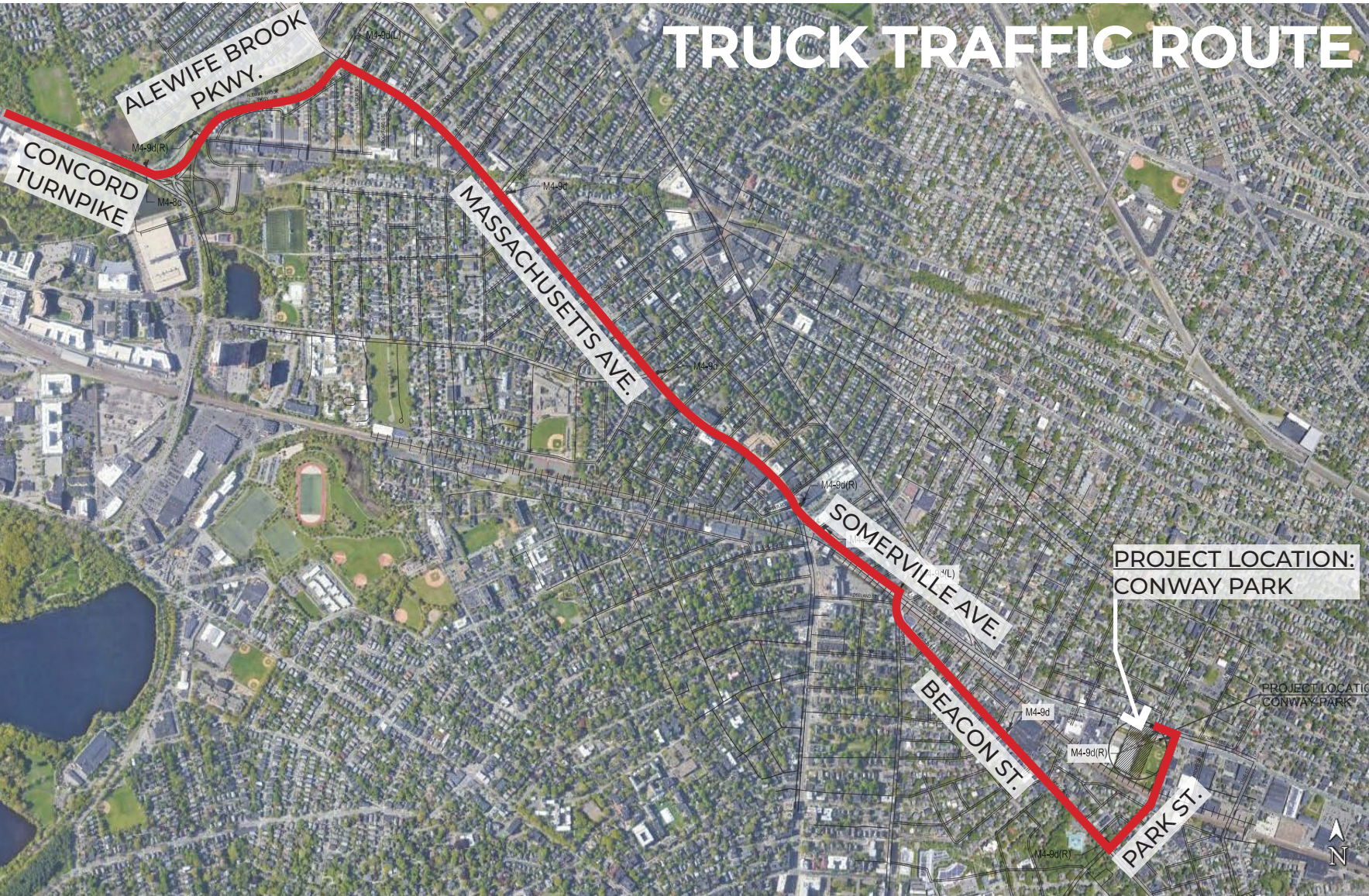

**TRUCK TRAFFIC ROUTE**

**CYCLIST AND PEDESTRIAN SAFETY:**

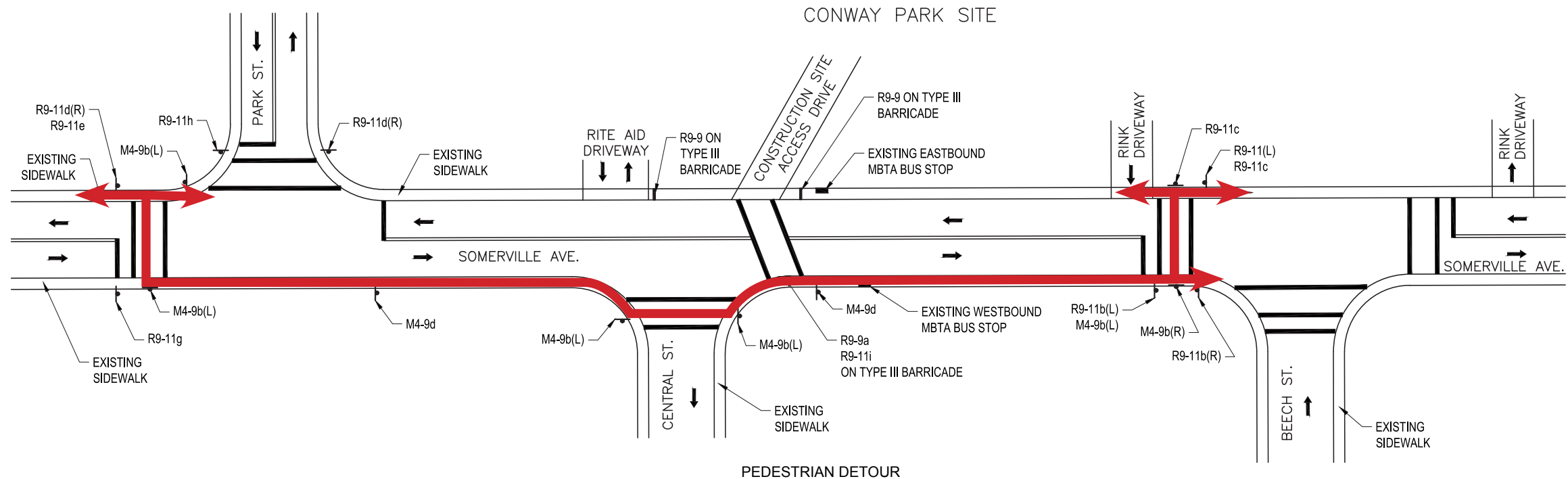

**PHASE 1 COMMUNITY IMPACTS**  
CONWAY PARK





## EPA REMOVAL PROGRAM:

Emergency Planning and Response Branch (EPRB)

- Utilizes Superfund to perform short-term cleanups of hazardous substances to protect human health and the environment
- Provides technical and project management assistance

1. Contaminated soil ( $\geq$  50 ppm PCBs) excavated, removed, & disposed of off-site

2. Backfill area with soils below 50 ppm PCBs

3. Install a barrier (geotextile fabric)

*\*EPA Funds can only be used for remediation*

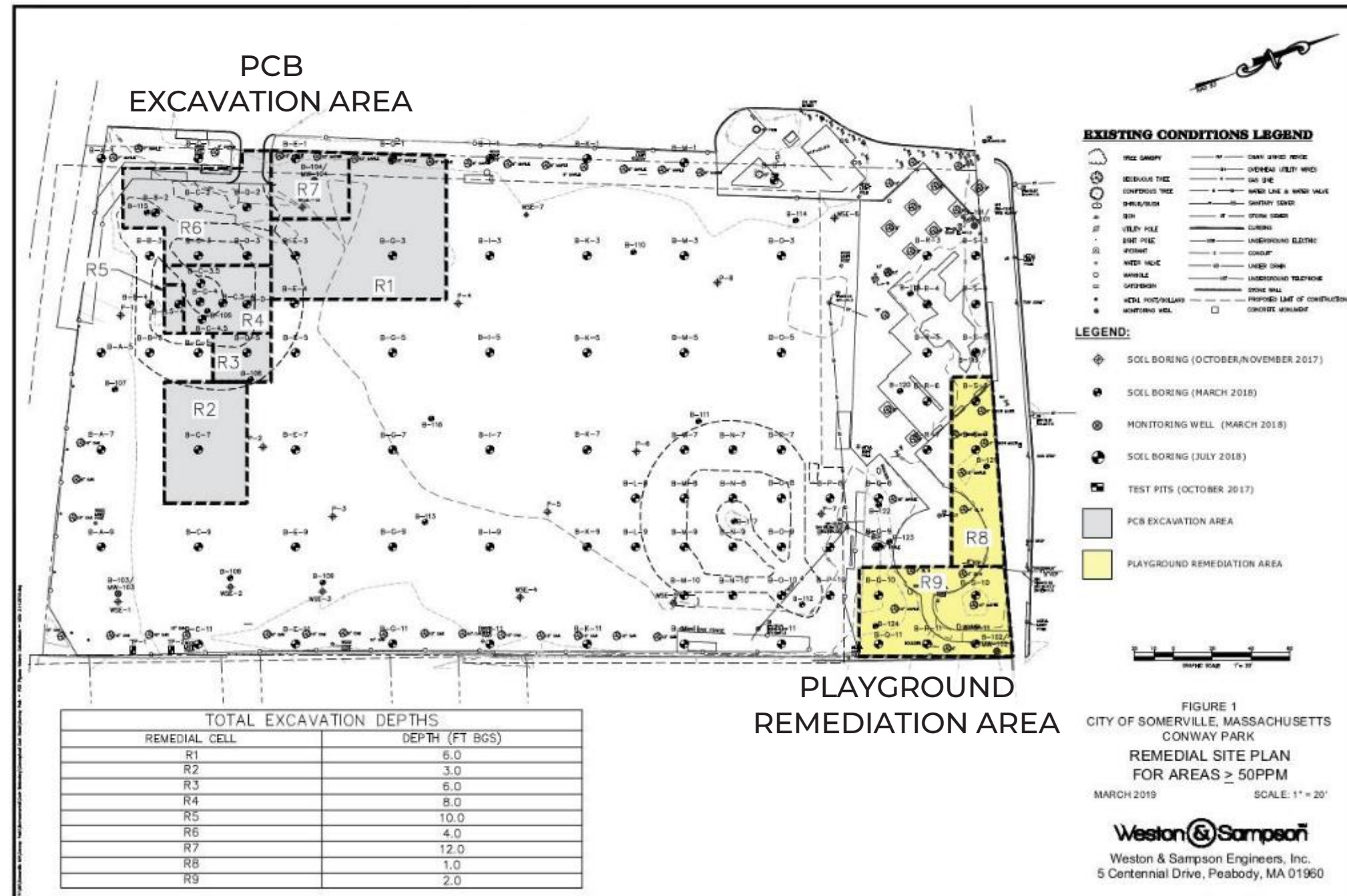

## PHASE 2: EPA REMEDIATION CONWAY PARK





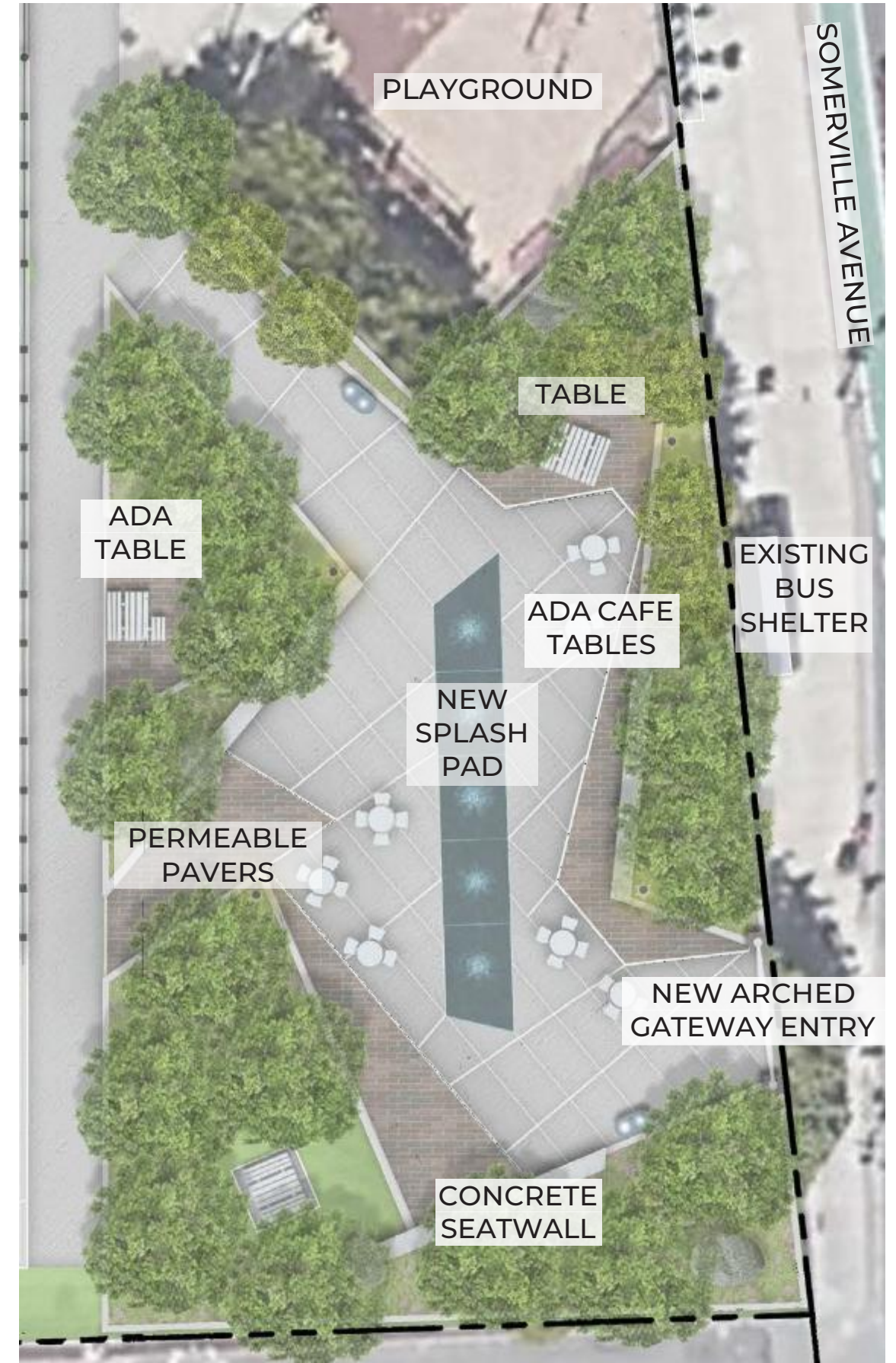
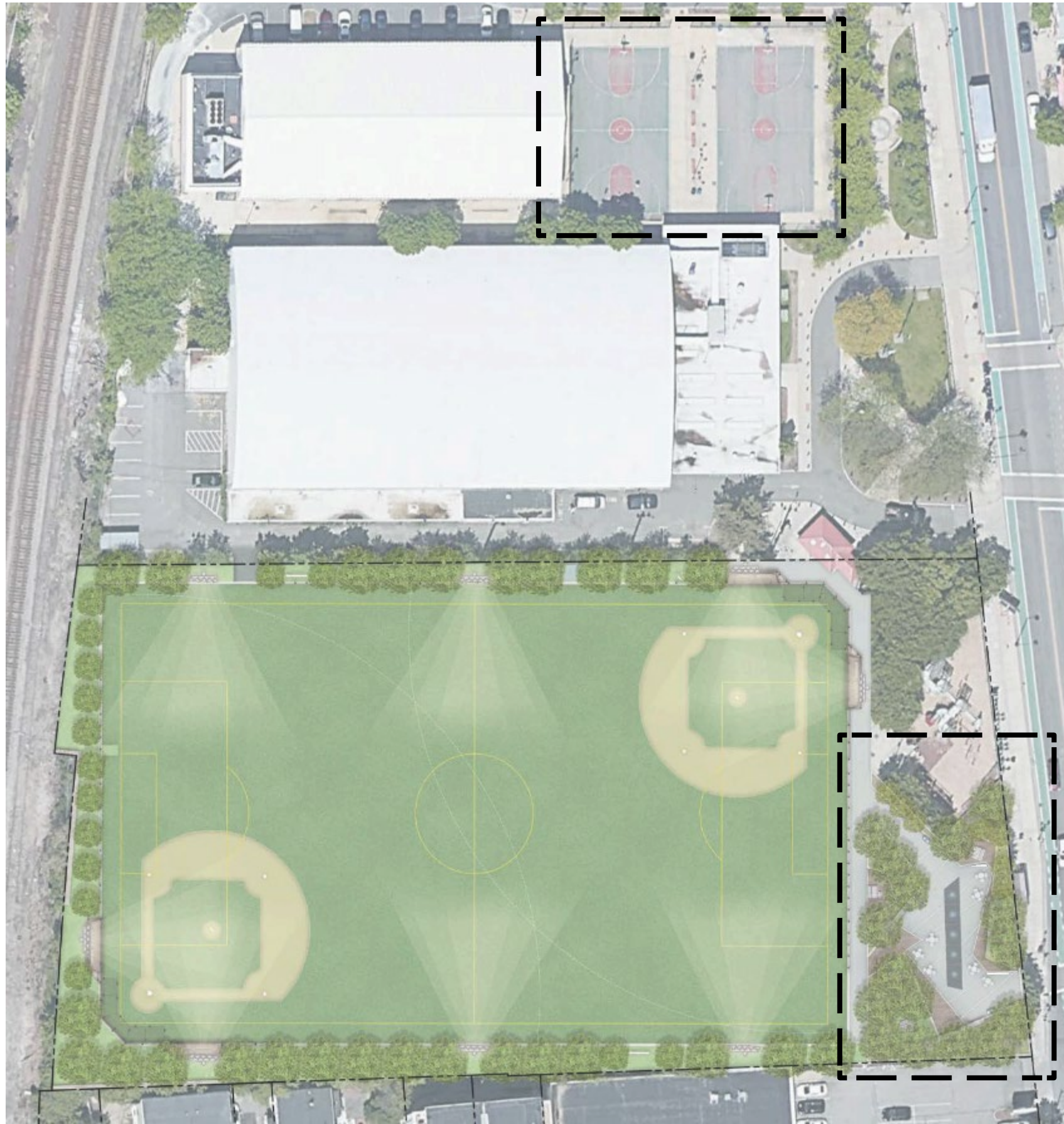

# PHASE 3 and PHASE 4

## CONWAY PARK







**Freeman Maple**  
*Acer x freemanii*

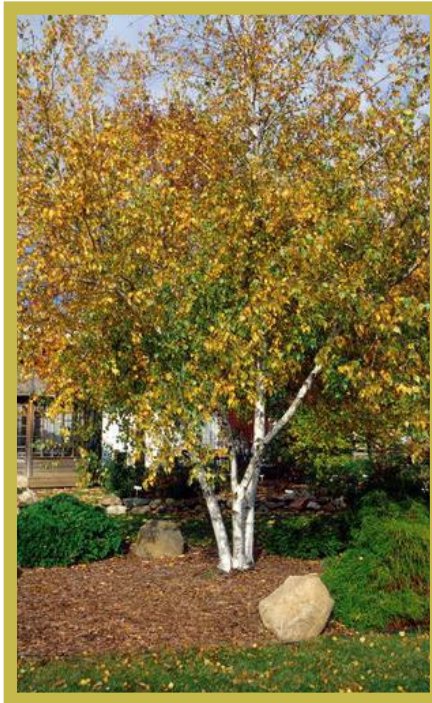

**Sweet Birch**  
*Betula lenta*



**River Birch**  
*Betula nigra*



**Maidenhair Tree**  
*Ginkgo biloba*  
*'fastigiata'*

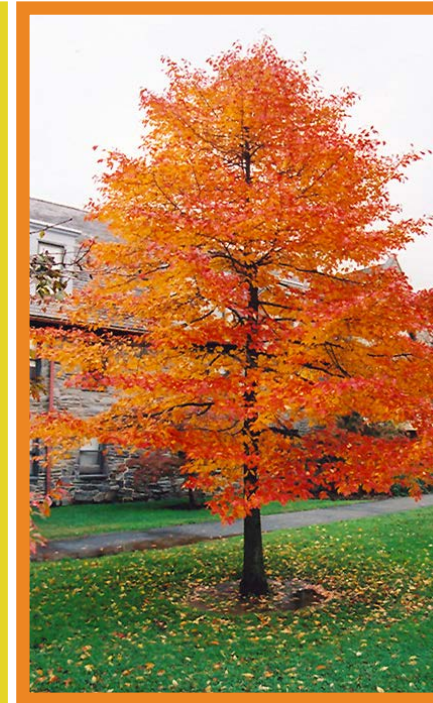

**Tupelo**  
*Nyssa sylvatica*



**Pin Oak**  
*Quercus palustris*



**American Linden**  
*Tilia americana*

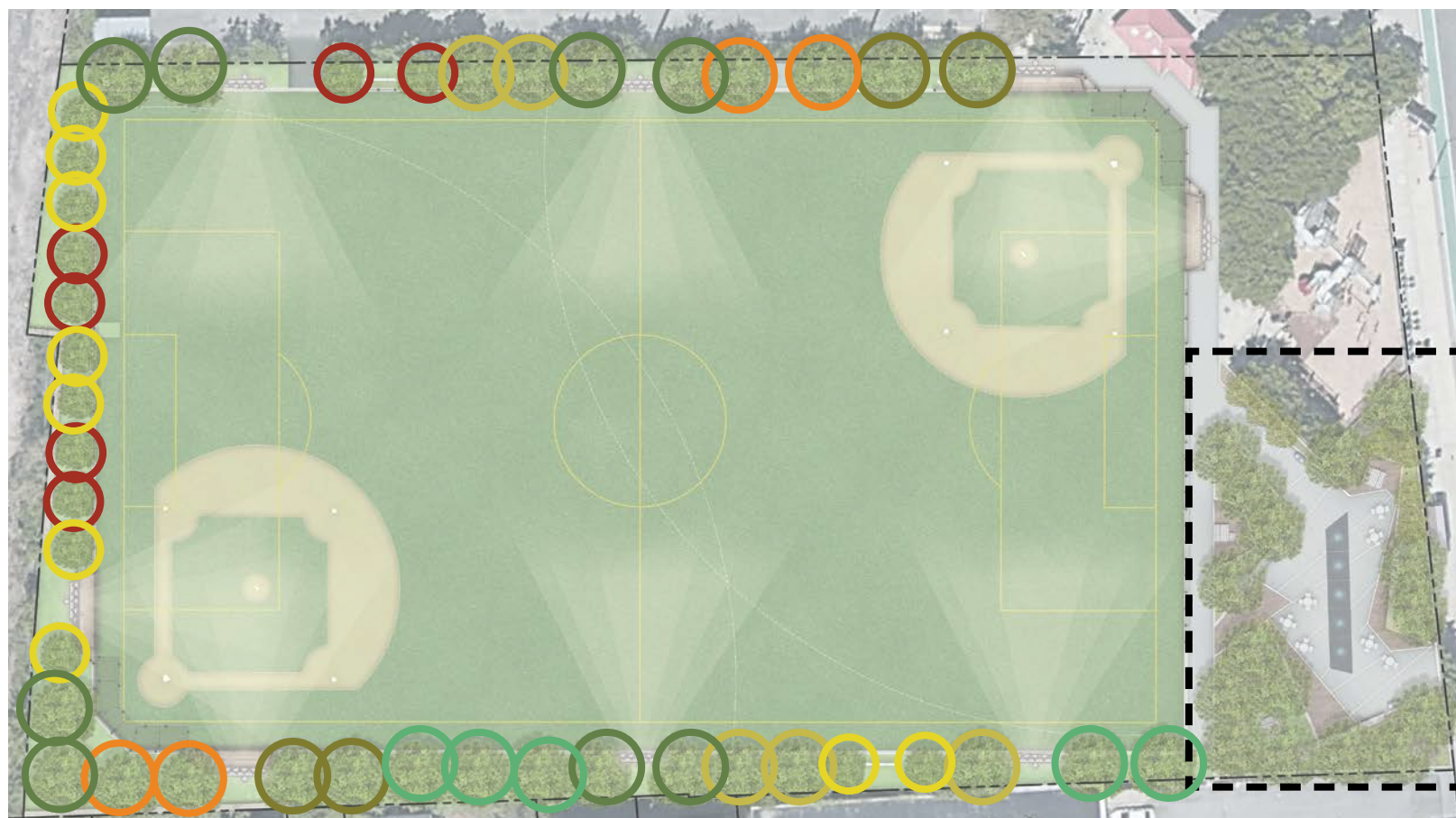

**UNDERSTORY NATIVE POLLINATOR PLANT LIST:**

**Dwarf Bush Honeysuckle**

*Diervilla lonicera*

**Dwarf Fothergilla**

*Fothergilla gardenii*

**Common Yarrow**

*Achillea millefolium*

**Butterfly Milkweed**

*Asclepias tuberosa*

**Coneflower**

*Echinacea purpurea*

*'PowWow White'*

**Little Bluestem Grass**

*Schizachyrium scoparium*

**Smokey Serviceberry**

*Amelanchier alnifolia*



**PHASE 3 and PHASE 4**

CONWAY PARK





## AIR MONITORING:

- Perimeter monitoring and worker safety monitoring
- Dust Control Measures – wetting and foam if needed
- Geotextile placement over impacted soil

## POLLUTION CONTROL:

- Erosion control around Catch basins and abutting MBTA

## TRANSPORT & DISPOSAL OF CONTAMINATED MATERIAL:

- Location's TBD – All out of state

## REGULATORY SIGN-OFF PROCESS:

- Final Reports to EPA and MassDEP

## CAPPING OF THE SITE & FINAL CONDITION:

- Synthetic Turf Detail

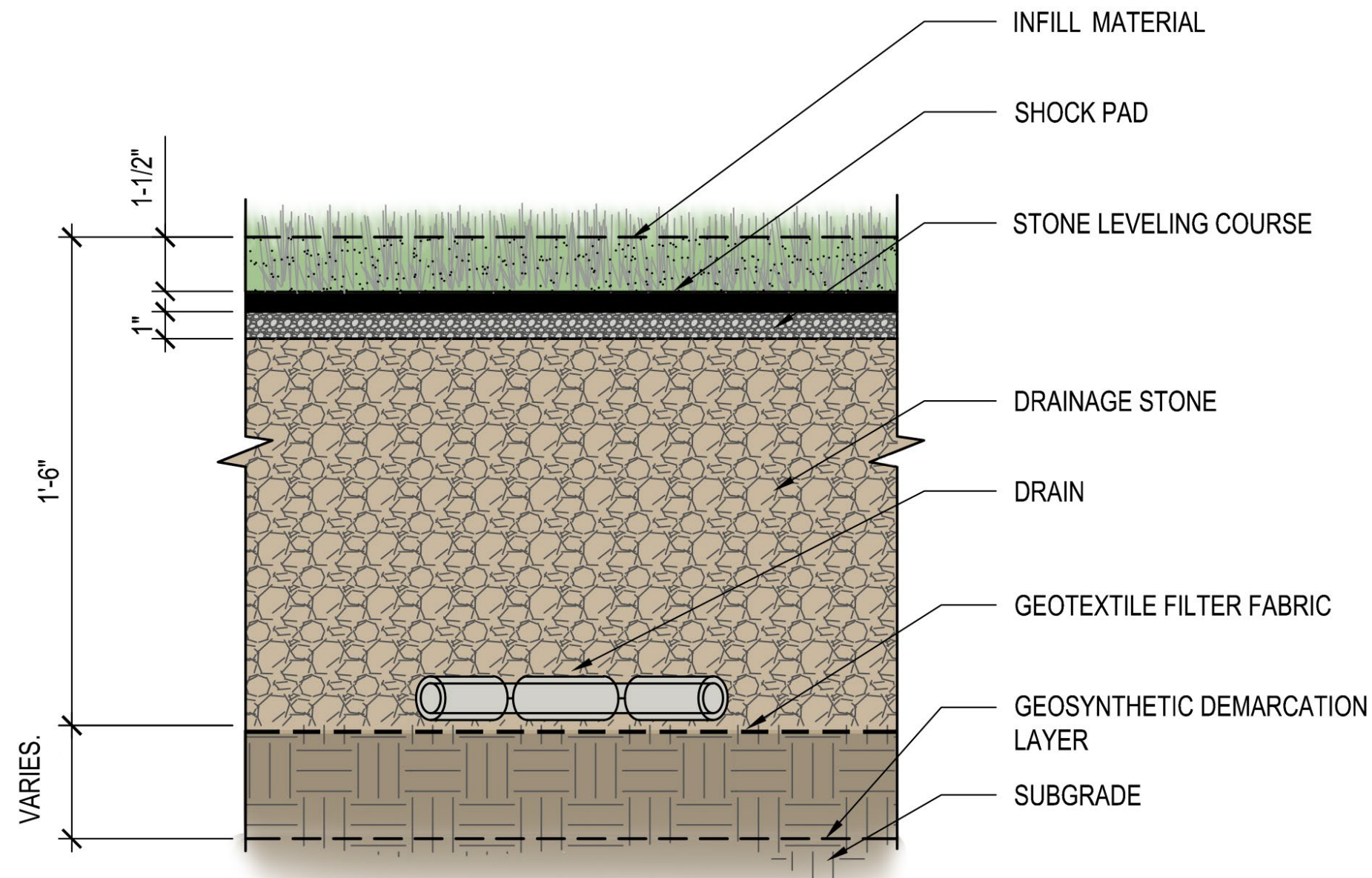

# COMMUNITY IMPACTS AND SAFETY MEASURES

## CONWAY PARK



# ANTICIPATED SCHEDULE

---

- February 2021 – *Project Out to Bid*
- March 24, 2021 – *Community Safety Meeting*
- Spring 2021 – *Anticipated Started Date*
- Summer 2021– *Phase 2 Remediation*
- Fall 2021– *Field Construction*
- Spring 2022 – *Anticipated Completion Date*

CONWAY'S PROJECT PAGE:

<https://www.somervillema.gov/departments/conway-field-and-playground-contamination>

*Posted in: local newspapers, social media, cable wheel, City calendar, City Council, Portuguese, Spanish, and Haitian Kreyol liaisons*

PROJECT SCHEDULE AND NEXT STEPS

CONWAY PARK



# NEXT STEPS

---

- City Contractor Selected
- Spring Mobilization – Fencing, Wall Construction, Stripping soil. Playground will be closed
- Heavy Equipment arriving in Spring – remediation early Summer
- Park construction in Fall

## CONWAY'S PROJECT PAGE:

<https://www.somervillema.gov/departments/conway-field-and-playground-contamination>

*Posted in: local newspapers, social media, cable wheel, City calendar, City Council, Portuguese, Spanish, and Haitian Kreyol liaisons*

## PROJECT SCHEDULE AND NEXT STEPS

CONWAY PARK





# KEY CONTACTS

---

**Zanetta Purnell**, EPA Community Involvement Coordinator

U.S Department of Environmental Protection Agency

Email: [purnell.zanetta@epa.gov](mailto:purnell.zanetta@epa.gov)

**Erik Johnson**, Environmental Analyst Bureau of Waste Site Cleanup

MassDEP, Northeast Regional Office

Email: [erik.johnson@state.ma.us](mailto:erik.johnson@state.ma.us)

**Andrew Louw**, Project Manager

City of Somerville, Public Space and Urban Forestry

Email: [alouw@somervillema.gov](mailto:alouw@somervillema.gov)





THANK YOU!  
COMMENTS & QUESTIONS ?

CONWAY'S PROJECT PAGE:

<https://www.somervillema.gov/departments/conway-field-and-playground-contamination>

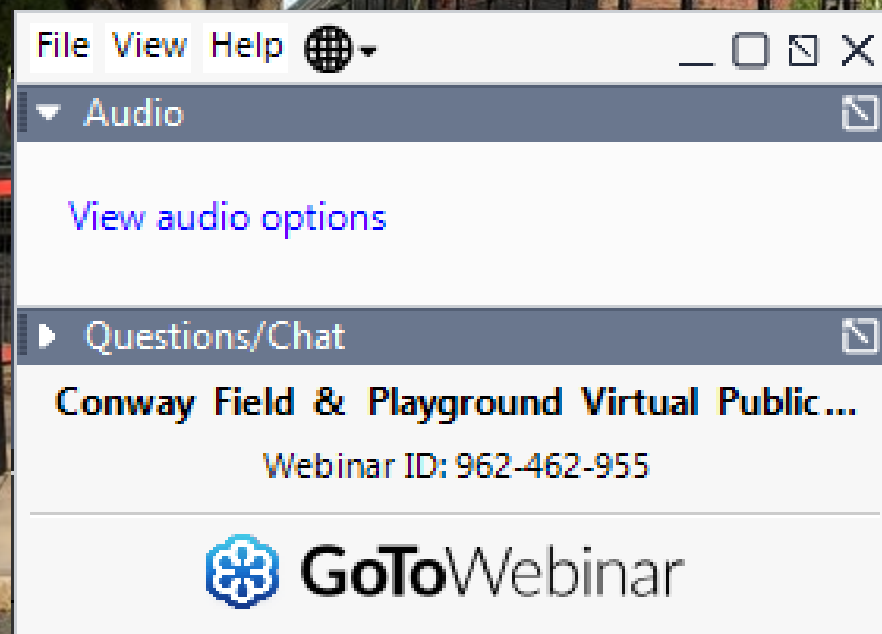
PLEASE TYPE COMMENTS & QUESTIONS IN THE CHAT:



File View Help  \_ □ ✕

▼ Audio 

[View audio options](#)

► Questions/Chat 

**Conway Field & Playground Virtual Public...**  
Webinar ID: 962-462-955

 **GoTo**Webinar

