

9 SANBORN COURT
SOMERVILLE, MA
1 7 0 0 - 1 1

JOURNEYMAN RESTAURANT ADDITION #1

SANBORN COURT
[PRIVATE WAY]

Existing Primary Egress
and Entrance

Existing Secondary Egress

Other Tenant Space

Existing Seating Area
for 34 Patrons

Common Access Corridor

Other Tenant Space

Existing Kitchen

Eating Bar

Accessible
Toilet Room
(Existing)

Toilet Room
(Existing)

Toilet Room
(Existing)

Dish Room
(Existing)

Other Tenant Space

Supply
Closet

Service
Corridor

Bar

Dish Pit

Plating Station

Wine Storage

New Seating Area
for 37 Patrons

Mechanical

Storage

2011 APR 29 AM 8:59

RECEIVED
S.P.C.D. AND
PLANNING DEPT.

INDICATES NEW
NON BEARING PARTITION WALL.

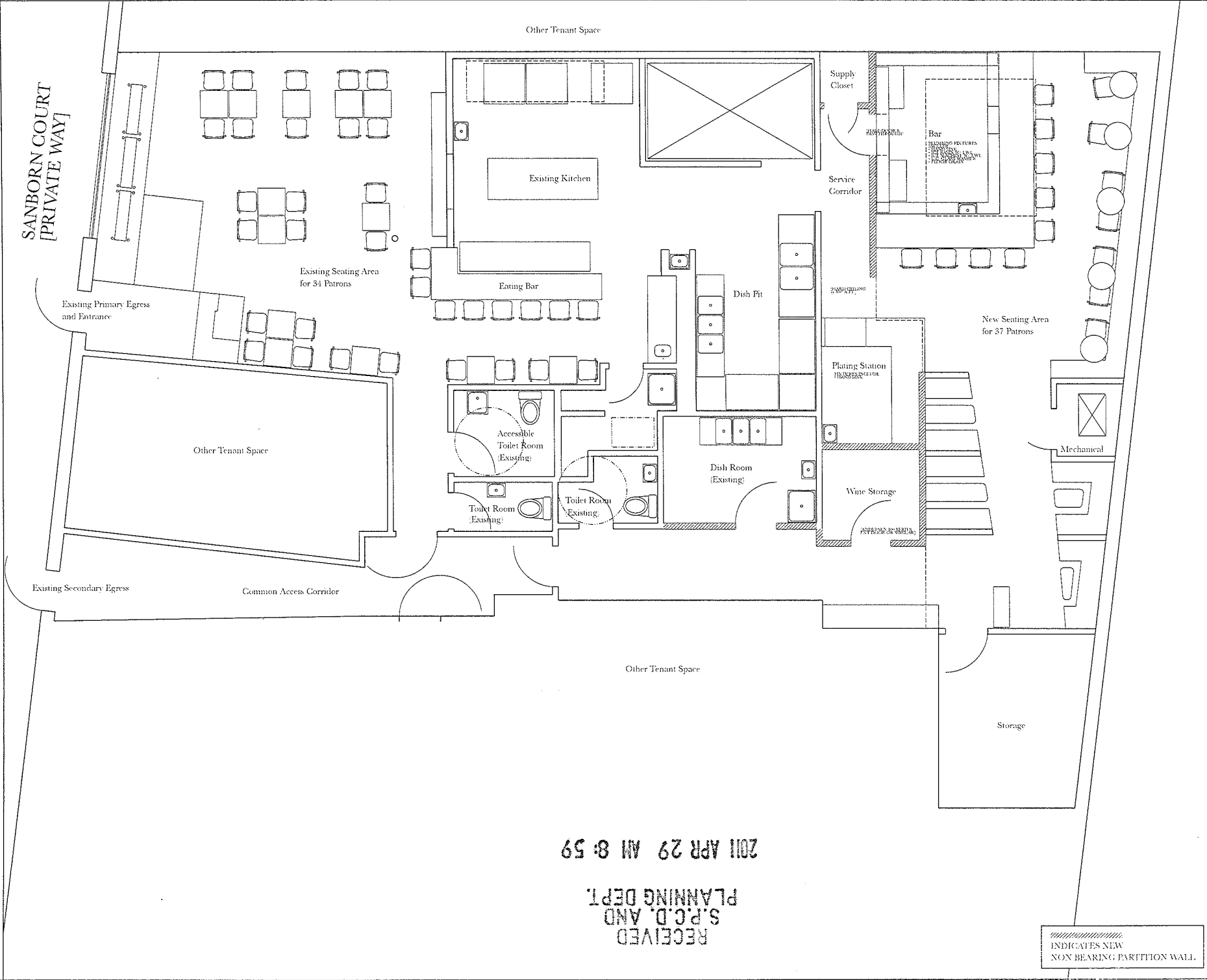

9 SANBORN COURT
SOMERVILLE, MA
1 7 4 4 - 1 1

JOURNEYMAN RESTAURANT ADDITION

#2

SANBORN COURT
[PRIVATE WAY]

Existing Primary Egress
and Entrance

Existing Secondary Egress

Existing Journeyman Restaurant
1460 Square Feet
Occupancy = 36 Customers & 6 Staff

Existing Seating Area
for 34 Patrons

Other Tenant Space

Common Access Corridor

Other Tenant Space

Existing Kitchen

Eating Bar

Accessible
Toilet Room
(Existing)

Toilet Room
(Existing)

Toilet Room
(Existing)

Dish Room
(Existing)

Dish Pit

Plating Station
(EXISTING)

Wine Storage

Supply Closet

Service
Corridor

Bar

New Seating Area
for 37 Patrons

Mechanical

Other Tenant Space

Storage

Addition to Journeyman Restaurant
1344 Square Feet
Occupancy = 37 Customers & 6 Staff

Journeyman Restaurant
9 Sanborn Court
Somerville, MA
Existing Restaurant and Planned Addition

2011 APR 29 AM 8:59

RECEIVED
S.P.C. AND
PLANNING DEPT.

INDICATES ADDITION TO
RESTAURANT CENTER OF WALL

INDICATES NEW
NON BEARING PARTITION WALL